

WATER WELL RECORD Form WWC-5

Original Record Correction Change in Well Use

Division of Water Resources App. No.

Well ID

1 LOCATION OF WATER WELL: County, Fraction, Section Number, Township Number, Range Number

2 WELL OWNER: Last Name, Business, Address, City, State, ZIP, Street or Rural Address where well is located

3 LOCATE WELL WITH 'X' IN SECTION BOX: N, W, E, S

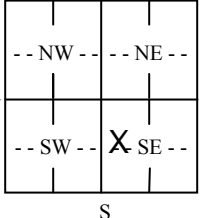

4 DEPTH OF COMPLETED WELL: Depth(s) Groundwater Encountered, WELL'S STATIC WATER LEVEL, Pump test data, Estimated Yield, Bore Hole Diameter

5 Latitude, Longitude, Datum, Source for Latitude/Longitude, GPS, Land Survey, Topographic Map, Online Mapper

6 Elevation: Ground Level, TOC, Source: Land Survey, GPS, Topographic Map, Other

7 WELL WATER TO BE USED AS: 1. Domestic, 2. Irrigation, 3. Feedlot, 4. Industrial, 5. Public Water Supply, 6. Dewatering, 7. Aquifer Recharge, 8. Monitoring, 9. Environmental Remediation, 10. Oil Field Water Supply, 11. Test Hole, 12. Geothermal, 13. Other

Was a chemical/bacteriological sample submitted to KDHE? Water well disinfected?

8 TYPE OF CASING USED: Steel, PVC, Other, CASING JOINTS: Glued, Clamped, Welded, Threaded, TYPE OF SCREEN OR PERFORATION MATERIAL: Steel, Stainless Steel, PVC, Other, SCREEN OR PERFORATION OPENINGS ARE: Continuous Slot, Mill Slot, Gauze Wrapped, Torch Cut, Drilled Holes, Other, SCREEN-PERFORATED INTERVALS, GRAVEL PACK INTERVALS

9 GROUT MATERIAL: Neat cement, Cement grout, Bentonite, Other, Grout Intervals, Nearest source of possible contamination: Septic Tank, Sewer Lines, Watertight Sewer Lines, Other, Lateral Lines, Cess Pool, Seepage Pit, Pit Privy, Sewage Lagoon, Feedyard, Livestock Pens, Fuel Storage, Fertilizer Storage, Insecticide Storage, Abandoned Water Well, Oil Well/Gas Well

Table with 6 columns: FROM, TO, LITHOLOGIC LOG, FROM, TO, LITHO. LOG (cont.) or PLUGGING INTERVALS. Includes a Notes section.

11 CONTRACTOR'S OR LANDOWNER'S CERTIFICATION: This water well was constructed, reconstructed, or plugged under my jurisdiction and was completed on (mo-day-year) and this record is true to the best of my knowledge and belief.

Send one copy to WATER WELL OWNER and retain one for your records. Fee of \$5.00 for each constructed well.

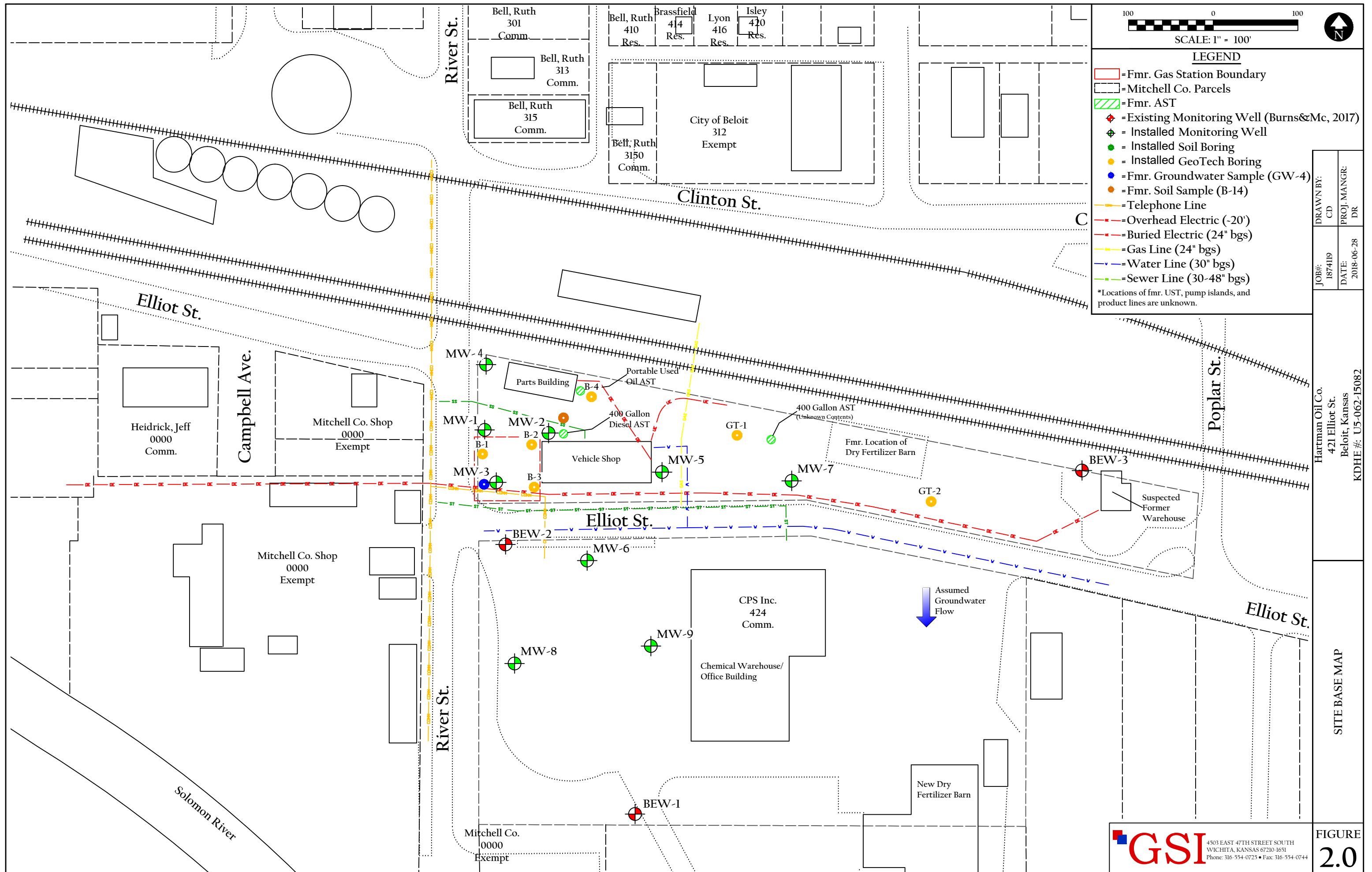

DRAWN BY:	CD
PROJECT MGR:	DR
JOB#:	187419
DATE:	2018-06-28

Hartman Oil Co.
421 Elliot St.
Beloit, Kansas
KDHE #: U5-062-15082

SITE BASE MAP