

WATER WELL RECORD Form WWC-5

Original Record Correction Change in Well Use

Division of Water Resources App. No.

Well ID

Well ID

1 LOCATION OF WATER WELL: County: Fraction Section Number Township Number Range Number

2 WELL OWNER: Last Name: Business: Address: City: State: ZIP: Street or Rural Address where well is located

3 LOCATE WELL WITH 'X' IN SECTION BOX: N W E S

4 DEPTH OF COMPLETED WELL: Depth(s) Groundwater Encountered: WELL'S STATIC WATER LEVEL: Pump test data: Estimated Yield: Bore Hole Diameter:

5 Latitude: Longitude: Datum: Source for Latitude/Longitude: 6 Elevation: Source:

7 WELL WATER TO BE USED AS: 1. Domestic: 2. Irrigation: 3. Feedlot: 4. Industrial: 5. Public Water Supply: 6. Dewatering: 7. Aquifer Recharge: 8. Monitoring: 9. Environmental Remediation: 10. Oil Field Water Supply: 11. Test Hole: 12. Geothermal: 13. Other

Was a chemical/bacteriological sample submitted to KDHE? Water well disinfected?

8 TYPE OF CASING USED: CASING JOINTS: Casing diameter: Casing height above land surface: TYPE OF SCREEN OR PERFORATION MATERIAL: SCREEN OR PERFORATION OPENINGS ARE: SCREEN-PERFORATED INTERVALS: GRAVEL PACK INTERVALS:

9 GROUT MATERIAL: Grout Intervals: Nearest source of possible contamination: Direction from well? Distance from well?

Table with 6 columns: FROM, TO, LITHOLOGIC LOG, FROM, TO, LITHO. LOG (cont.) or PLUGGING INTERVALS. Includes a Notes section.

11 CONTRACTOR'S OR LANDOWNER'S CERTIFICATION: This water well was constructed, reconstructed, or plugged under my jurisdiction and was completed on (mo-day-year) and this record is true to the best of my knowledge and belief.

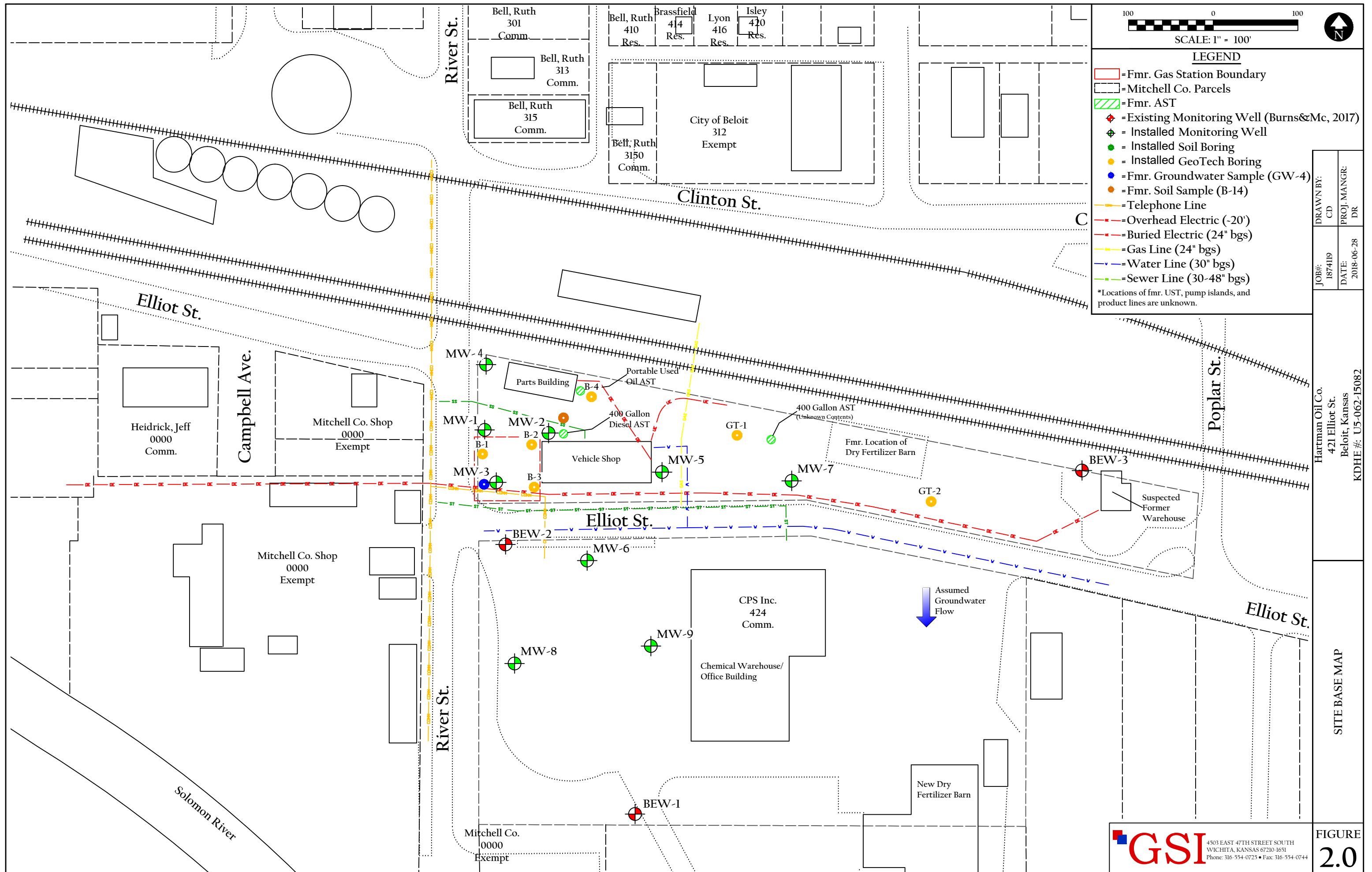

DRAWN BY:	CD
PROJECT MGR:	DR
JOB#:	187419
DATE:	2018-06-28

Hartman Oil Co.  
421 Elliot St.  
Beloit, Kansas  
KDHE #: U5-062-15082

SITE BASE MAP