

**1 LOCATION OF WATER WELL:** County: Graham Fraction SW 1/4 SW 1/4 SW 1/4 Section Number 12 Township Number 8 Range Number 23 EW

Distance and direction from nearest town or city street address of well if located within city?

322 West Main Street Hill City

**2 WATER WELL OWNER:** JULE M WINTER  
 RR#, St. Address, Box #: 322 West Main St  
 City, State ZIP Code: Hill City, KS 67642  
 Global Positioning Systems (decimal degrees, min. of 4 digits)  
 Latitude: 39.36548  
 Longitude: -99.84458  
 Elevation: 2793.27  
 Datum: \_\_\_\_\_  
 Data Collection Method: Survey

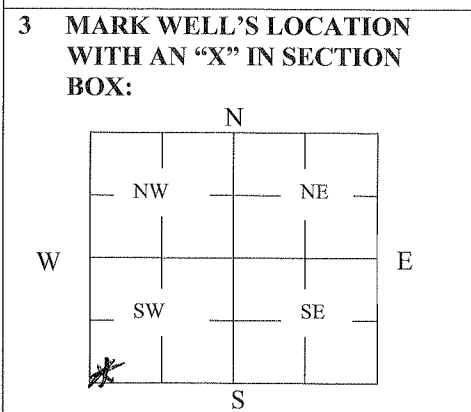

**4 DEPTH OF WELL** 58.50 ft.  
 WELL'S STATIC WATER LEVEL 39.79 ft.  
 WELL WAS USED AS:  
 1 Domestic                      5 Public Water Supply                      9 Dewatering  
 2 Irrigation                      6 Oil Field Water Supply                      10 Monitoring  
 3 Feedlot                          7 Domestic (Lawn & Garden)                      11 Injection Well  
 4 Industrial                      8 Air Conditioning                          12 Other \_\_\_\_\_  
 Was a chemical/bacteriological sample submitted to Department? Yes \_\_\_\_\_ No

**5 TYPE OF BLANK CASING USED:**  
 1 Steel                      3 RMP (SR)                      5 Wrought                      7 Fiberglass                      9 Other (Specify below)  
2 PVC                      4 ABS                          6 Asbestos-Cement                      8 Concrete Tile  
 Blank casing diameter 2" in. Was casing pulled? Yes  No \_\_\_\_\_ If yes, how much 6'  
 Casing height above or below land surface 80 in.

**6 GROUT PLUG MATERIAL:** 1 Neat cement                      2 Cement grout                      3 Bentonite                      4 Other \_\_\_\_\_  
 Grout Plug Intervals: From 58.5 ft. to 58.5 ft., From \_\_\_\_\_ ft. to \_\_\_\_\_ ft., From \_\_\_\_\_ to \_\_\_\_\_ ft.  
 What is the nearest source of possible contamination:  
 1 Septic tank                      6 Seepage pit                      11 Fuel Storage                      16 Other (specify below)  
 2 Sewer lines                      7 Pit privy                          12 Fertilizer storage                      ABANDON TANKS  
 3 Watertight sewer lines                      8 Sewage lagoon                      13 Insecticide storage  
 4 Lateral lines                      9 Feedyard                          14 Abandoned water well                      Direction from well? WEST  
 5 Cess pool                          10 Livestock pens                      15 Oil well/Gas well                      How many feet? 750

FROM	TO	PLUGGING MATERIALS	FROM	TO	PLUGGING MATERIALS
<u>58.5</u>	<u>7.0</u>	<u>Bentonite Chips</u>			

**7 CONTRACTOR'S OR LANDOWNER'S CERTIFICATION:** This water well was plugged under my jurisdiction and was completed on (mo/day/year) 12/15/10 and this record is true to the best of my knowledge and belief. Kansas Water Well Contractor's License No. \_\_\_\_\_ This Water Well Record was completed on (mo/day/year) 12/15/10 under the business name of Tank Management Services by (signature) [Signature]

**INSTRUCTIONS:** Use typewriter or ballpoint pen. Please press firmly and print clearly. Please fill in blanks, underline or circle the correct answers. Send top three copies to Kansas Department of Health and Environment, Bureau of Water, Geology Section, 1000 SW Jackson St., Ste. 420, Topeka, Kansas 66612-1367. Telephone: 785/296-5522. Send one to Water Well Owner and retain one for your records. Visit us at <http://www.kdheks.gov/geo/waterwells>.