

Wmw C

WATER WELL PLUGGING RECORD Form WWC-5P KSA 82a-1212 ID NO. 00249263

1 LOCATION OF WATER WELL: County: Graham Fraction SW 1/4 SW 1/4 SW 1/4 Section Number 12 Township Number B 5 Range Number 23 E/W W

Distance and direction from nearest town or city street address of well if located within city? 322 West Main Street Hill City, KS

2 WATER WELL OWNER: Sule M Winters Global Positioning Systems (decimal degrees, min. of 4 digits) Latitude: 39.3659769 Longitude: -99.8445861 RR#, St. Address, Box #: 322 W. Main Street Elevation: _____ Datum: _____ City, State ZIP Code: Hill City Kansas 67642 Data Collection Method: _____

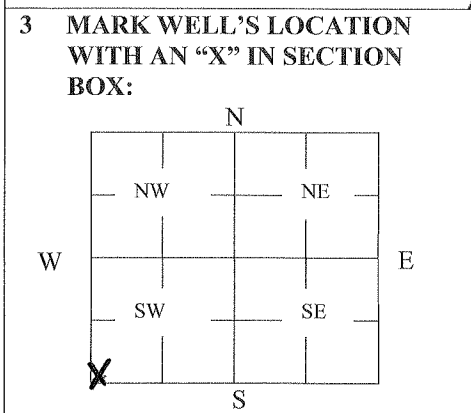

3 MARK WELL'S LOCATION WITH AN "X" IN SECTION BOX: 4 DEPTH OF WELL 55.0 ft. WELL'S STATIC WATER LEVEL 40.22 ft. WELL WAS USED AS: 1 Domestic 2 Irrigation 3 Feedlot 4 Industrial 5 Public Water Supply 6 Oil Field Water Supply 7 Domestic (Lawn & Garden) 8 Air Conditioning 9 Dewatering 10 Monitoring 11 Injection Well 12 Other _____ Was a chemical/bacteriological sample submitted to Department? Yes _____ No X

5 TYPE OF BLANK CASING USED: 1 Steel 2 PVC 3 RMP (SR) 4 ABS 5 Wrought 6 Asbestos-Cement 7 Fiberglass 8 Concrete Tile 9 Other (Specify below) _____ Blank casing diameter 2.5 in. Was casing pulled? Yes X No _____ If yes, how much 36" Casing height above or below land surface -36 in.

6 GROUT PLUG MATERIAL: 1 Neat cement 2 Cement grout 3 Bentonite 4 Other _____ Grout Plug Intervals: From 55 ft. to 3 ft., From _____ ft. to _____ ft., From _____ to _____ ft. What is the nearest source of possible contamination: 1 Septic tank 2 Sewer lines 3 Watertight sewer lines 4 Lateral lines 5 Cess pool 6 Seepage pit 7 Pit privy 8 Sewage lagoon 9 Feedyard 10 Livestock pens 11 Fuel Storage 12 Fertilizer storage 13 Insecticide storage 14 Abandoned water well 15 Oil well/Gas well 16 Other (specify below) _____ Direction from well? NW How many feet? 75

FROM	TO	PLUGGING MATERIALS	FROM	TO	PLUGGING MATERIALS
<u>55</u>	<u>3</u>	<u>BENTONITE CHIPS</u>	<u>3</u>	<u>1</u>	<u>SOIL</u>

7 CONTRACTOR'S OR LANDOWNER'S CERTIFICATION: This water well was plugged under my jurisdiction and was completed on (mo/day/year) 6/16/11 and this record is true to the best of my knowledge and belief. Kansas Water Well Contractor's License No. 6116/11. This Water Well Record was completed on (mo/day/year) 6/20/11 under the business name of Tank Management SUS. by (signature) [Signature]

INSTRUCTIONS: Use typewriter or ballpoint pen. Please press firmly and print clearly. Please fill in blanks, underline or circle the correct answers. Send top three copies to Kansas Department of Health and Environment, Bureau of Water, Geology Section, 1000 SW Jackson St., Ste. 420, Topeka, Kansas 66612-1367. Telephone: 785/296-5522. Send one to Water Well Owner and retain one for your records. Visit us at http://www.kdheks.gov/geo/waterwells.

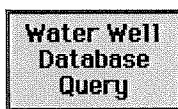
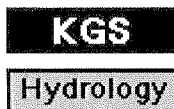

Specific Water Well Detail

Well T8S, R23W, Sec. 12, SW SW SW, Action: Constructed

Location Info	
County: Graham	Location: T8S, R23W, Sec. 12, SW SW SW
Owner: Winters, Jule M.	Status: Constructed
Directions: 322 W Main St, Hill City	
Longitude: -99.8445861	Latitude: 39.3654769
Longitude and latitude calculated by Survey from township-range-section-quarter calls. Only good to within the quarter call accuracy.	
View well on interactive map This link will create a new window and display an interactive map of this well and its neighbors.	
General Info	
Well Depth: 55 ft.	Elevation: ft.
Static Water Level: 41.69 ft.	Well Use: Monitoring well/observation/piezometer
Est. Yield: gpm.	Other ID: WMW 2
Driller Info	
Driller: Quad State Services, Inc.	License #: 692
Comp. Date: 04-Jan-2006	DWR Applic. #:
Scanned Form	
View scan of this form in PDF format.	
You will need the Acrobat PDF Reader , available free from Adobe, to read this file.	

Kansas Geological Survey
 Comments to webadmin@kgs.ku.edu
 URL=<http://www.kgs.ku.edu/Magellan/WaterWell/index.html>
 Display Programs Updated July 29, 2004
 Data added continuously.

RECEIVED
 JUN 20 2011
 BUREAU OF WATER

1 LOCATION OF WATER WELL:	Fraction	Section Number	Township Number	Range Number
County: Graham	SW 1/4 SW 1/4 SW 1/4	12	T 8 S	R 23 E

Distance and direction from nearest town or city street address of well if located within city?

322 W. Main Street, Hill City, Kansas

2 WATER WELL OWNER: Jule M. Winters	Board of Agriculture, Division of Water Resources
RR#, St. Address, Box # : 322 W. Main Street	Application Number:
City, State, ZIP Code : Hill City, Kansas 67642	

3 LOCATE WELL'S LOCATION WITH AN "X" IN SECTION BOX:

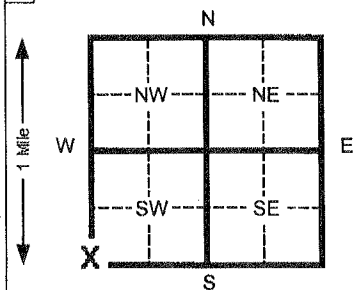

4 DEPTH OF COMPLETED WELL	55.0 ft.	ELEVATION:	
Depth(s) Groundwater Encountered	1 45.7 ft.	2	3
WELL'S STATIC WATER LEVEL	41.69 ft. below land surface	measured on	02/22/06
Pump test data:	Well water was	ft. after	hours pumping
Est. Yield	NA gpm	Well water was	ft. after
Bore Hole Diameter	8.5 in. to 55.0 ft.	and	in. to
WELL WATER TO BE USED AS:	5 Public water supply	8 Air conditioning	11 Injection well
	1 Domestic	3 Feed lot	6 Oil field water supply
	2 Irrigation	4 Industrial	7 Lawn and garden (domestic)
			9 Dewatering
			12 Other (Specify below)
Was a chemical/bacteriological sample submitted to Department?	Yes	No	<input checked="" type="checkbox"/> If yes, mo/day/yr sample was submitted
Water Well Disinfected?	Yes	No	<input checked="" type="checkbox"/>

5 TYPE OF BLANK CASING USED:	5 Wrought Iron	8 Concrete tile	CASING JOINTS: Glued	Clamped
1 Steel	3 RMP (SR)	6 Asbestos-Cement	9 Other (specify below)	Welded
<input checked="" type="radio"/> PVC	4 ABS	7 Fiberglass		Threaded
Blank casing diameter	2.375 in. to 35.0 ft.	Dia	in. to	ft. Dia
Casing height above land surface	Flush Mount in., weight	lbs./ft.	Wall thickness or gauge No.	Schedule 40
TYPE OF SCREEN OR PERFORATION MATERIAL:	<input checked="" type="radio"/> PVC	10 Asbestos-cement		
1 Steel	3 Stainless steel	5 Fiberglass	8 RMP (SR)	11 Other (specify)
2 Brass	4 Galvanized steel	6 Concrete tile	9 ABS	12 None used (open hole)
SCREEN OR PERFORATION OPENINGS ARE:	5 Gauzed wrapped	8 Saw cut	11 None (open hole)	
1 Continuous slot	<input checked="" type="radio"/> Mill slot	6 Wire wrapped	9 Drilled holes	
2 Louvered shutter	4 Key punched	7 Torch cut	10 Other (specify)	
SCREEN-PERFORATED INTERVALS:	From 55.0 ft. to 35.0 ft.	From	ft. to	ft.
GRAVEL PACK INTERVALS:	From 55.0 ft. to 32.0 ft.	From	ft. to	ft.

6 GROUT MATERIAL:	1 Neat cement	<input checked="" type="radio"/> Cement grout	<input checked="" type="radio"/> Bentonite	4 Other
Grout intervals	From 0.0 ft. to 2.0 ft.	From 2.0 ft. to 32.0 ft.	From	ft. to
What is the nearest source of possible contamination:	1 Septic tank	4 Lateral lines	7 Pit privy	<input checked="" type="radio"/> Livestock pens
	2 Sewer lines	5 Cess pool	8 Sewage lagoon	<input checked="" type="radio"/> Fuel storage
	3 Watertight sewer lines	6 Seepage pit	9 Feedyard	13 Insecticide storage
				14 Abandoned water well
				15 Oil well/ Gas well
				16 Other (specify below)
Direction from well?	Northwest	How many feet?	75	

FROM	TO	CODE	LITHOLOGIC LOG
0.0	1.0		Gravel and Sand
1.0	2.5		Brown-red brown very silty clay, firm, slightly moist
2.5	18.0		Brown-red brown silt, friable, slightly moist-dry, trace odor 15-18.0'
18.0	28.0		Brown-light red brown very fine-fine grained sand, silty, caliche stringers, slightly moist, trace odor, strong odor 25.0-28.0'
28.0	30.5		Yellow chalk, very silty, some caliche fragments, friable, moist, strong odor
30.5	52.5		Brown-gray brown very fine-medium grained sand, silty, moist-very moist, strong odor, slight gray staining
52.5	54.0		White chalk, hard
54.0	55.0		Dark gray shale, hard (Pierre Shale)
Flush-mount well completion approved by D. Taylor, KDHE-BOW.			

7 CONTRACTOR'S OR LANDOWNER'S CERTIFICATION: This water well was <input checked="" type="radio"/> constructed, <input type="radio"/> reconstructed, or <input type="radio"/> plugged under my jurisdiction and was completed on (mo/day/yr) 01/04/06 and this record is true to the best of my knowledge and belief. Kansas Water Well Contractor's License No. 692 This Water Well Record was completed on (mo/day/yr) 03/21/06 under the business name of Quad State Services, Inc. by (signature) <i>[Signature]</i>

INSTRUCTIONS: Please fill in blanks and circle the correct answers. Send three copies to Kansas Department of Health and Environment, Bureau of Water, 1000 SW Jackson St., Ste. 420, Topeka, Kansas 66612-1367. Telephone: 913-296-5545. Send one to WATER WELL OWNER and retain one for your records.

RECEIVED

JUN 20 2011

BUREAU OF WATER

OFFICE USE ONLY

T

R

SEC