

CORRECTION(S) TO WATER WELL RECORD (Form WWC-5)

(to rectify lacking or incorrect information)

LOCATION OF WATER WELL: County: <u>Thomas</u>	Fraction <u>NW ¼ NW ¼ NE ¼ NE ¼</u>	Section <u>1</u>	Township T <u>8</u> S	Range R <u>34</u> <input type="checkbox"/> E <input checked="" type="checkbox"/> W
---	--	---------------------	--------------------------	---

Owner: City of Colby

Location was listed as:

Sec. 1 T 7 S R 34 E W

Fraction: NW NW NE NE

Location changed to:

Sec. 1 T 8 S R 34 E W

Fraction: NW NW NE NE

Other changes: Initial statements: _____

Changed to: _____

Comments: plugging form for MW 12

Verification method: Interactive Map and correspondents with MILCO Environmental Services, Inc.

initials: DRL date: 11-17-2016

Submitted by: Kansas Geological Survey, Data Resources Library, 1930 Constant Ave., Lawrence, KS 66047-3726
to: Kansas Dept of Health & Environment, Bureau of Water, 1000 SW Jackson, Suite 420, Topeka, KS 66612-1367.

WATER WELL PLUGGING RECORD Form WWC-5P

KSA 82a-1212

ID NO.

MW 12

1 LOCATION OF WATER WELL: County: Thomas	Fraction NW ¼ NW ¼ NE ¼ NE ¼	Section Number 1	Township Number T 7 S	Range Number 34 <input type="checkbox"/> E <input checked="" type="checkbox"/> W
--	---------------------------------	---------------------	--------------------------	---

Street/Rural Address of Well Location; if unknown, distance & direction from nearest town or intersection: If at owner's address, check here Colby Public Power, Colby

Global Positioning Systems (GPS) information:

Latitude: _____ (in decimal degrees)
 Longitude: _____ (in decimal degrees)
 Elevation: _____
 Horizontal Datum: WGS84, NAD83, NAD27
 Collection Method:
 GPS unit (Make/Model: _____)
 Digital Map/Photo, Topographic Map, Land Survey
 Est. Accuracy: < 3 m, 3-5 m, 5-15 m, > 15 m

2 WATER WELL OWNER: City of Colby
 RR#, St. Address, Box #: 585 N. Franklin
 City, State ZIP Code: Colby, Kansas 67701

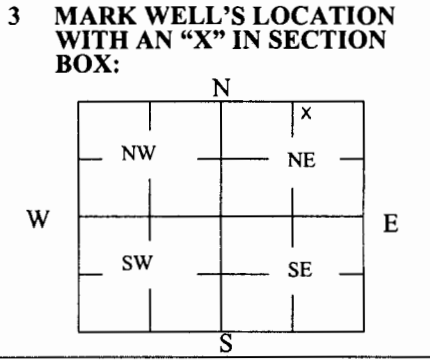

4 DEPTH OF WELL 137.30 **ft.**
 WELL'S STATIC WATER LEVEL Dry **ft**
 WELL WAS USED AS:
 Domestic Public Water Supply Dewatering
 Irrigation Oil Field Water Supply Monitoring MW-12
 Feedlot Domestic (Lawn & Garden) Injection Well
 Industrial Air Conditioning Other _____
 Was a chemical/bacteriological sample submitted to Department? Yes No

5 TYPE OF BLANK CASING USED:

Steel RMP (SR) Wrought Fiberglass Other (Specify below) _____
 PVC ABS Asbestos-Cement Concrete Tile _____

Blank casing diameter 4 in. Was casing pulled? Yes No If yes, how much 3'
 Casing height above or below land surface 36 in.

6 GROUT PLUG MATERIAL: Neat cement Cement grout Bentonite Other _____

Grout Plug Intervals: From 3 ft. to 137.3 ft., From _____ ft. to _____ ft., From _____ ft. to _____ ft.

What is the nearest source of possible contamination:
 Septic tank Seepage pit Fuel storage Other (specify below) _____
 Sewer lines Pit privy Fertilizer storage _____
 Watertight sewer lines Sewage lagoon Insecticide storage _____
 Lateral lines Feedyard Abandoned water well Direction from well? _____
 Cess pool Livestock pens Oil well/Gas well How many feet? _____

FROM	TO	PLUGGING MATERIALS	FROM	TO	PLUGGING MATERIALS
0	3	Native soil			Note: Location of well listed incorrectly as
3	137.30	Bentonite grout			NW1/4 NW1/4 NE1/4 on original
					well record.

7 CONTRACTOR'S OR LANDOWNER'S CERTIFICATION: This water well was plugged under my jurisdiction and was completed on (mo/day/year) 8-22-16 and this record is true to the best of my knowledge and belief. Kansas Water Well Contractor's License No. 735. This Water Well Record was completed on (mo/day/year) 9/27/16 under the business name of MILCO Environmental Services, Inc. by (signature) *[Handwritten Signature]*

Send one white copy to Kansas Department of Health & Environment, Geology Section, 1000 SW Jackson Street, Ste. 420, Topeka, KS 66612-1367. Send one copy to WATER WELL OWNER and retain one for your records.
 Visit us at <http://www.kdheks.gov/waterwell/index.html> Telephone 785-296-5524.

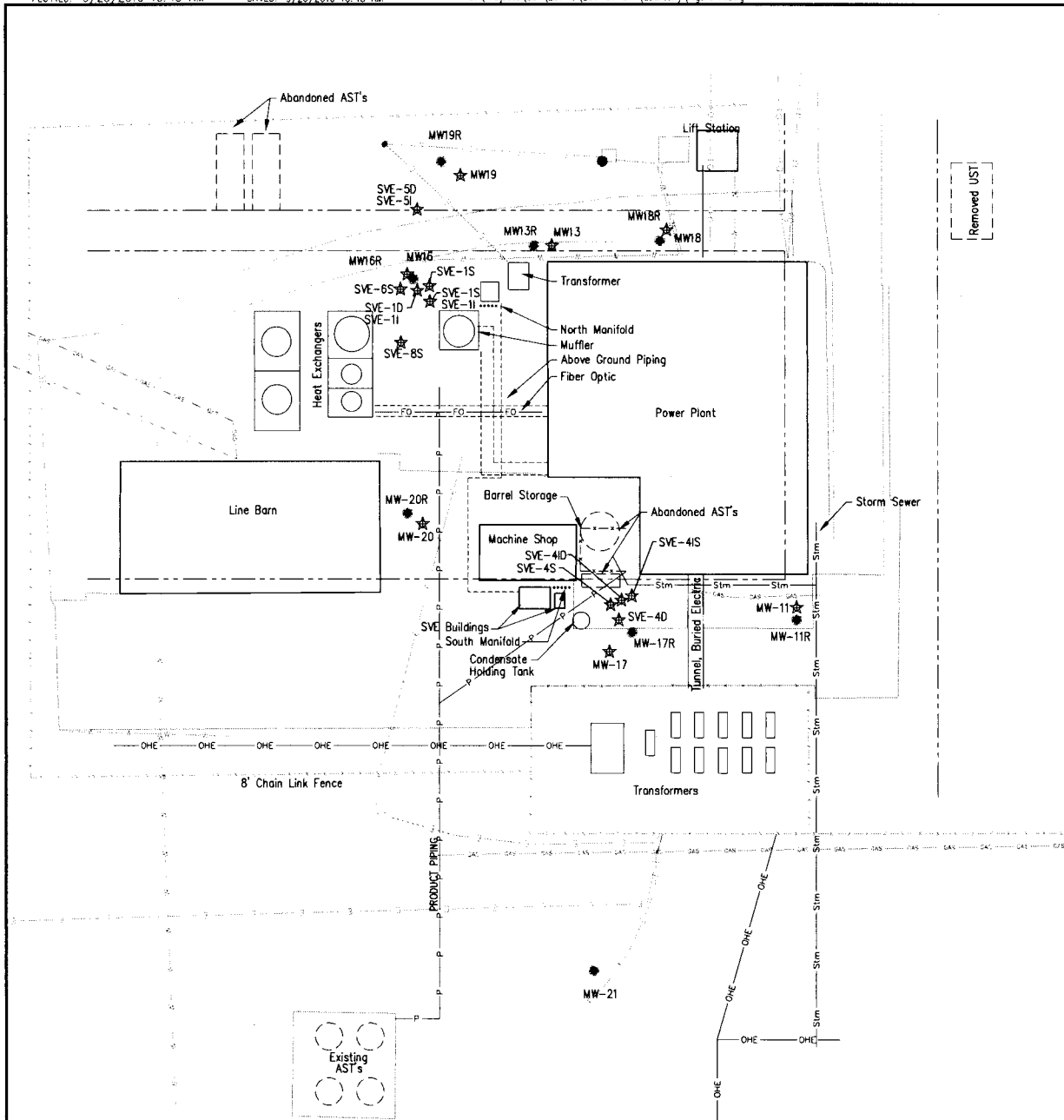

Point Designation	Coordinates		Latitude	Longitude	Top of Rim Elevation	Top of Casing Elevation
	North	West				
MW-11R	26.042	1000.73	39.3942772	101.0582967	3164.18	3163.79
MW-12R	-196.765	1191.15	39.3936718	101.0589795	3162.60	3162.30
MW-13R	170.13	1102.90	39.3946760	101.0586522	3165.00	3164.31
MW-16R	157.456	1149.72	39.3946427	101.0588184	3165.15	3164.75
MW-17R	21.12	1064.83	39.3942658	101.0585237	3164.55	3164.16
MW-18R	172.084	105388	39.3946798	101.0584788	3164.87	3164.45
MW-19R	202.526	1138.74	39.3947661	101.0587776	3165.34	3165.05
MW-20R	67.06	1151.91	39.3943947	101.0588298	3164.61	3164.16
MW-21	-109.27	1079.71	39.3939084	101.0585817	3163.04	3162.41

MW-12R
★ MW-12

NAD 83

(per surveyor via driller)

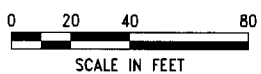

LEGEND	
⊕	= MONITORING WELL
★	= ABANDONED MONITORING WELL

FIGURE A

DATE: 08-24-11

SCALE: AS SHOWN

PROJECT NO: 08-01-11

DRAWN BY: JAR/DB

CHECKED BY: JAR/DB

FIELD BOOK: 1044 (104)

NO. OF SHEETS: 10

SHEET: 10

COLBY PUBLIC POWER

SITE PLAN

120 NORTH STERLING, COLBY, KS A6-097-40187

This document, and the ideas and designs incorporated herein, are an instrument of professional service, the property of MILCO and is not to be used in whole or in part, for any other project without the written authorization of © 2005 MILCO.

MILCO

Environmental Services, Inc.

1200 N. 10th St. Suite 200

Colby, KS 66746-1586

Phone: 785.866.1586

Fax: 785.866.1586