

USE TYPEWRITER OR BALL POINT PEN-PRESS FIRMLY, PRINT CLEARLY.

WATER WELL RECORD  
KSA 82a-1201-1215

ABA

Kansas Department of Health and Environment-Division of Environment (Water well Contractors) Topeka, Kansas 66620

1. Location of well: County **SHERMAN** Fraction **NE 1/4NW 1/4 NE 1/4** Section number **2** Township number **T 8 S R 39** Range number **E/W**

2. Distance and direction from nearest town or city: **#4 miles North, #4 East of Goodland, KS**  
Street address of well location if in city:  
3. Owner of well: **Harry M. Armstrong**  
R.R. or street: **Route 2, Box 9**  
City, state, zip code: **Goodland, KS 67735**

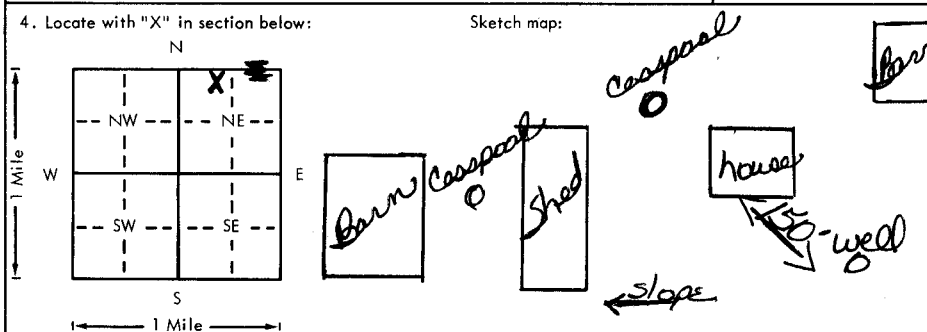

6. Bore hole dia. **8** in. Completion date \_\_\_\_\_  
Well depth **328** ft. **1-8-80**

7.  Cable tool  Rotary  Driven  Dug  
 Hollow rod  Jetted  Bored  Reverse rotary

8. Use:  Domestic  Public supply  Industry  
 Irrigation  Air conditioning  Stock  
 Lawn  Oil field water  Other

9. Casing: Material **plastic** Height: Above or below \_\_\_\_\_  
Threaded \_\_\_\_\_ Welded \_\_\_\_\_ Surface **12** in.  
RMP \_\_\_\_\_ PVC  Weight \_\_\_\_\_ lbs./ft.  
Dia. **4** in. to **308** ft. depth Wall Thickness: inches or \_\_\_\_\_  
Dia. \_\_\_\_\_ in. to \_\_\_\_\_ ft. depth Gauge No. **237**

5. Type and color of material	From	To
Topsoil	0	4
Clay	4	66
M. Gravel, Gravel	66	76
Clay, Sandy Clay, Sand Stone	76	93
M. Gravel, Sandy Clay	93	106
M. Gravel, Sand Stone	106	123
Sandy Clay, Sand Stone	123	132
M. Gravel, Gravel	132	143
M. Gravel, Sandy Clay, Sand Stone	143	166
Sandy Clay, Sand Stone	166	178
M. Gravel, Sandy Clay, Sand Stone	178	189
M. Gravel	189	198
Fine Sand, M. Gravel, Sandy Clay, Sand Stone	198	209
Fine Sand, Sandy Clay, Sand Stone	209	234
M. Gravel, Gravel, Sand Stone	234	248
Hard Sand Stone	248	251
Sandy Clay, Sand Stone	251	258
Sandy Clay, Rock, Hard Sand Stone	258	264
Clay, Sand Stone	264	268
M. Gravel, Sandy Clay, Sand Stone	268	278
Clay	278	287
Fine Sand, Sandy Clay	287	312
M. Gravel	312	323
Chert, Blue Shale (Use a second sheet if needed)	323	331

10. Screen: Manufacturer's name **Pearless**  
Type **Louver** Dia. **5"**  
Slot/gauze **1/8 .258** Length **20'**  
Set between **308** ft. and **328** ft.  
\_\_\_\_\_ ft. and \_\_\_\_\_ ft.  
Gravel pack? **yes** Size range of material **1/8**

11. Static water level: \_\_\_\_\_ mo./day/yr.  
**178** ft. below land surface Date **12-21-79**

12. Pumping level below land surfaces:  
**203** ft. after **3** hrs. pumping **15** g.p.m.  
\_\_\_\_\_ ft. after \_\_\_\_\_ hrs. pumping \_\_\_\_\_ g.p.m.  
Estimated maximum yield **50** g.p.m.

13. Water sample submitted: \_\_\_\_\_ mo./day/yr.  
Yes  No  Date \_\_\_\_\_

14. Well head completion:  
 Pitless adapter **12** inches above grade

15. Well grouted? **yes**  
With:  Neat cement  Bentonite  Concrete  
Depth: From **5** ft. to **15** ft.

16. Nearest source of possible contamination:  
ft. **150** Direction **NW** Type **cesspool**  
Well disinfected upon completion?  Yes  No

17. Pump: Not installed  
Manufacturer's name **Red Jacket**  
Model number **1100** HP **1 1/2** Volts **230**  
Length of drop pipe **238** ft. capacity **15** g.p.m.  
Type:  
 Submersible  Turbine  
 Jet  Reciprocating  
 Centrifugal  Other

18. Elevation: \_\_\_\_\_ 19. Remarks: **BROCK 323**

Topography:  
 Hill  
 Slope  
 Upland  
 Valley

20. Water well contractor's certification:  
This well was drilled under my jurisdiction and this report is true to the best of my knowledge and belief.  
**S & H Drilling** **166**  
Business name \_\_\_\_\_ license No. \_\_\_\_\_  
Address **Goodland, KS 67735**  
Signed **Bill Clifford** Date **1-8-80**  
Authorized representative

8-390-2-NE 1/4 NW 1/4