

WATER WELL RECORD

Form WWC-5

Division of Water Resources App. No.

1 LOCATION OF WATER WELL:
 County: Cloud Fraction SE 1/4 NW 1/4 SW 1/4 1/4
 Section Number 23 Township No. T 8 S Range Number R 4 E W
 Street/Rural Address of Well Location; if unknown, distance & direction from nearest town or intersection: If at owner's address, check here **Global Positioning System (GPS) information:**
 Latitude: 39.34036 (in decimal degrees)
 Longitude: 97.73739 (in decimal degrees)
 Elevation: 1466 ft
 Datum: WGS 84, NAD 83, NAD 27
 Collection Method:
 GPS unit (Make/Model: Garmin ETREX)
 Digital Map/Photo, Topographic Map, Land Survey
 Est. Accuracy: <3 m, 3-5 m, 5-15 m, >15 m

2 WATER WELL OWNER: Lindsey Hale
 RR#, Street Address, Box #: 224 N 100th
 City, State, ZIP Code: Delphos, KS 67436

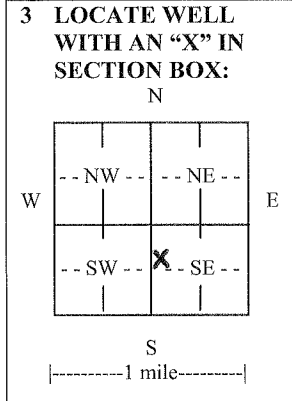

4 DEPTH OF COMPLETED WELL 120 ft.
 Depth(s) Groundwater Encountered (1) 25 ft. (2) 90 ft. (3) _____ ft.
 WELL'S STATIC WATER LEVEL 100 ft. below land surface measured on mo/day/yr. 6/30/11
 Pump test data: Well water was _____ ft. after _____ hours pumping _____ gpm
 EST. YIELD 20 gpm. Well water was _____ ft. after _____ hours pumping _____ gpm
 Bore Hole Diameter 10 in. to 120 ft., and _____ in. to _____ ft.
 WELL WATER TO BE USED AS: Public water supply Geothermal Injection well
 Domestic Feedlot Oil field water supply Dewatering Other (Specify below)
 Irrigation Industrial Domestic-lawn & garden Monitoring well
 Was a chemical/bacteriological sample submitted to Department? Yes No
 If yes, mo/day/yr sample was submitted. _____
 Water well disinfected? Yes No

5 TYPE OF CASING USED: Steel PVC Other _____
 CASING JOINTS: Glued Clamped Welded Threaded
 Casing diameter 8 in. to 120 ft., Diameter _____ in. to _____ ft., Diameter _____ in. to _____ ft.
 Casing height above land surface 24 in., Weight _____ lbs./ft., Wall thickness or gauge No. _____
 TYPE OF SCREEN OR PERFORATION MATERIAL:
 Steel Stainless Steel PVC Other (Specify) _____
 Brass Galvanized Steel None used (open hole)
 SCREEN OR PERFORATION OPENINGS ARE:
 Continuous slot Mill slot Gauze wrapped Torch cut Drilled holes None (open hole)
 Louvered shutter Key punched Wire wrapped Saw cut Other (specify) _____
 SCREEN-PERFORATED INTERVALS: From 120 ft. to 100 ft., From _____ ft. to _____ ft.
 From _____ ft. to _____ ft., From _____ ft. to _____ ft.
 GRAVEL PACK INTERVALS: From 120 ft. to 25 ft., From _____ ft. to _____ ft.
 From _____ ft. to _____ ft., From _____ ft. to _____ ft.

6 GROUT MATERIAL: Neat cement Cement grout Bentonite Other _____
 Grout Intervals: From 0 ft. to 25 ft., From _____ ft. to _____ ft., From _____ ft. to _____ ft.
 What is the nearest source of possible contamination:
 Septic tank Lateral lines Pit privy Livestock pens Insecticide storage Other (specify below)
 Sewer lines Cesspool Sewage lagoon Fuel storage Abandoned water well
 Watertight sewer lines Seepage pit Feedyard Fertilizer storage Oil well/gas well pasture
 Direction from well South Distance from well 70

FROM	TO	LITHOLOGIC LOG	FROM	TO	LITHO. LOG (cont.) or PLUGGING INTERVALS
0	2	Topsoil			
2	5	Weathered Limestone			
5	25	Weathered Shale			
25	30	Fine Sand			
30	40	Shale			
40	90	Red Clay			
90	120	Sandstone			

7 CONTRACTOR'S OR LANDOWNER'S CERTIFICATION: This water well was constructed, reconstructed, or plugged under my jurisdiction and was completed on (mo/day/year) 6/30/11 and this record is true to the best of my knowledge and belief.
 Kansas Water Well Contractor's License No. 7100 This Water Well Record was completed on (mo/day/year) 8/18/11
 under the business name of Associated Drilling Inc. by (signature) Jacques Howland

INSTRUCTIONS: Use typewriter or ball point pen. PLEASE PRESS FIRMLY and PRINT clearly. Please fill in blanks and check the correct answers. Send three copies (white, blue, pink) to Kansas Department of Health and Environment, Bureau of Water, Geology Section, 1000 SW Jackson St., Suite 420, Topeka, Kansas 66612-1367. Telephone 785-296-5524. Send one copy to WATER WELL OWNER and retain one for your records. Include fee of \$500 for each constructed well. Visit us at <http://www.kdheks.gov/waterwell/index.html>.