

WATER WELL RECORD Form WWC-5

Original Record Correction Change in Well Use

Division of Water Resources App. No.

Well ID

1 LOCATION OF WATER WELL: County: CLOUD Fraction: SE 1/4 NE 1/4 NW 1/4 NE 1/4 Section Number: 14 Township Number: T 8 S Range Number: R 5 E W

2 WELL OWNER: Last Name: COOPER First: NAUMANN Street or Rural Address where well is located (if unknown, distance and direction from nearest town or intersection): If at owner's address, check here:
 Business: 503 E. MAIN
 Address: GLASCO State: Ks ZIP: 67445 503 E. MAIN

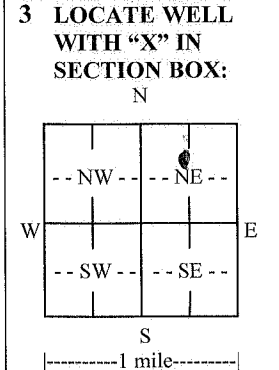

4 DEPTH OF COMPLETED WELL: 54 ft.
 Depth(s) Groundwater Encountered: 1) 22 ft.
 2) ft. 3) ft., or 4) Dry Well
 WELL'S STATIC WATER LEVEL: ft.
 below land surface, measured on (mo-day-yr) 5-28-13
 above land surface, measured on (mo-day-yr).....
 Pump test data: Well water was 50 ft. after..... hours pumping gpm
 Well water was ft. after..... hours pumping gpm
 Estimated Yield: 15 gpm
 Bore Hole Diameter: 9 in. to 5.5 ft. and in. to ft.

5 Latitude: (decimal degrees)
Longitude: (decimal degrees)
 Datum: WGS 84 NAD 83 NAD 27
 Source for Latitude/Longitude:
 GPS (unit make/model:)
 (WAAS enabled? Yes No)
 Land Survey Topographic Map
 Online Mapper:

6 Elevation: ft. Ground Level TOC
 Source: Land Survey GPS Topographic Map
 Other

7 WELL WATER TO BE USED AS:

1. Domestic: Household Lawn & Garden Livestock
 2. Irrigation
 3. Feedlot
 4. Industrial

5. Public Water Supply: well ID

6. Dewatering: how many wells?

7. Aquifer Recharge: well ID

8. Monitoring: well ID

9. Environmental Remediation: well ID

Air Sparge Soil Vapor Extraction
 Recovery Injection

10. Oil Field Water Supply: lease

11. Test Hole: well ID

Cased Uncased Geotechnical

12. Geothermal: how many bores?

a) Closed Loop Horizontal Vertical
 b) Open Loop Surface Discharge Inj. of Water

13. Other (specify):

Was a chemical/bacteriological sample submitted to KDHE? Yes No If yes, date sample was submitted:

Water well disinfected? Yes No

8 TYPE OF CASING USED: Steel PVC Other CASING JOINTS: Glued Clamped Welded Threaded
 Casing diameter 5 in. to 40 ft., Diameter in. to ft., Diameter in. to ft.
 Casing height above land surface 14 in. Weight 1160 lbs./ft. Wall thickness or gauge No. S&P 26
 TYPE OF SCREEN OR PERFORATION MATERIAL:
 Steel Stainless Steel Fiberglass PVC Other (Specify)
 Brass Galvanized Steel Concrete tile None used (open hole)
 SCREEN OR PERFORATION OPENINGS ARE:
 Continuous Slot Mill Slot 1005 Gauze Wrapped Torch Cut Drilled Holes Other (Specify)
 Louvered Shutter Key Punched Wire Wrapped Saw Cut None (Open Hole)
 SCREEN-PERFORATED INTERVALS: From 40 ft. to 54 ft., From ft. to ft., From ft. to ft.
 GRAVEL PACK INTERVALS: From 35 ft. to 54 ft., From ft. to ft., From ft. to ft.

9 GROUT MATERIAL: Neat cement Cement grout Bentonite Other
 Grout Intervals: From 0 ft. to 22 ft., From ft. to ft., From ft. to ft.

Nearest source of possible contamination:

Septic Tank Lateral Lines Pit Privy Livestock Pens Insecticide Storage
 Sewer Lines Cess Pool Sewage Lagoon Fuel Storage Abandoned Water Well
 Watertight Sewer Lines Seepage Pit Feedyard Fertilizer Storage Oil Well/Gas Well
 Other (Specify)

Direction from well? SOUTH Distance from well? 25 ft.

10 FROM	TO	LITHOLOGIC LOG	FROM	TO	LITHO. LOG (cont.) or PLUGGING INTERVALS
0	2	FINN DIRT			
2	22	CLAY FIRM BROWN			
22	38	SAND FINE TO MED. TAN			
38	55	SANDSTONE W/CLAY LAYERS			
55		SHALE RED TO GRAY			
Notes:					

11 CONTRACTOR'S OR LANDOWNER'S CERTIFICATION: This water well was constructed, reconstructed, or plugged under my jurisdiction and was completed on (mo-day-yr) 05-28-13 and this record is true to the best of my knowledge and belief. Kansas Water Well Contractor's License No. 388 This Water Well Record was completed on (mo-day-yr) 5/28/13 under the business name of P.E. STINEBAUGH PUMP & SERVICE