

#4

1 LOCATION OF WATER WELL: Fraction SE 1/4 SE 1/4 NE 20 Section Number 9 Township Number 18 Range Number E/W

County: Roos Distance and direction from nearest town or city street address of well if located within city? 2 West + 1/2 mile North of Junction Rd

2 WATER WELL OWNER: County of Marshall
 RR #, St. Address, Box #: 3119 Alexander Ave Board of Agriculture, Division of Water Resources
 City, State, ZIP Code: Hoop, Mo 67601 Application Number: _____

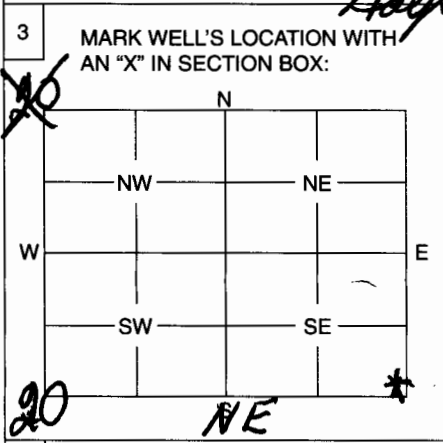

4 DEPTH OF WELL 21 ft.
 WELL'S STATIC WATER LEVEL 20 ft. ~~20~~
 WELL WAS USED AS:
 1 Domestic 5 Public Water Supply 9 Dewatering
 2 Irrigation 6 Oil Field Water Supply 10 Monitoring Well
 3 Feedlot 7 Domestic (Lawn & Garden) 11 Injection Well
 4 Industrial 8 Air Conditioning 12 Other livestock

Was a chemical / bacteriological sample submitted to Department? Yes No X.....
 If yes, mo/day/yr sample was submitted

Water Well Disinfected: Yes X..... No

5 TYPE OF BLANK CASING USED:
 1 Steel 3 RMP (SR) 5 Wrought 7 Fiberglass 9 Other (Specify below)
 2 PVC 4 ABS 6 Asbestos-Cement 8 Concrete Tile

Blank casing diameter 5 in. Was casing pulled? Yes X..... No If yes, how much 4'
 Casing height above or below land surface 14' in.

6 GROUT PLUG MATERIAL: 1 Neat cement 2 Cement grout 3 Bentonite 4 Other

Grout Plug Intervals: From 7 ft. to 3 ft., From ft. to ft., From to ft.

What is the nearest source of possible contamination:
 1 Septic tank 6 Seepage pit 11 Fuel storage 16 Other (specify below) Abandoned
 2 Sewer lines 7 Pit privy 12 Fertilizer storage
 3 Watertight sewer lines 8 Sewage lagoon 13 Insecticide storage
 4 Lateral lines 9 Feedyard 14 Abandoned water well
 5 Cess pool 10 Livestock pens 15 Oil well/Gas well

Direction from well? How many feet?

FROM	TO	PLUGGING MATERIALS
21	15	Sand
15	7	Compacted clays
7	3	Bentonite
3	0	Compacted clays

7 CONTRACTOR'S OR OWNER'S CERTIFICATION: This water well was plugged under my jurisdiction and was completed on (mo/day/year) 5/2/08 and this record is true to the best of my knowledge and belief. Kansas Water Well Contractor's License No. This Water Well Record was completed on (mo/day/year) under the business name of by (signature) Andy R. Marshall

INSTRUCTIONS: Use typewriter or ball point pen. Please press firmly and print clearly. Please fill in blanks, underline or circle the correct answers. Send top three copies to Kansas Department of Health and Environment, Bureau of Water, Geology Section, 1000 SW Jackson St., Ste. 420, Topeka, Kansas 66612-1367. Telephone: 785/296-5522. Send one to Water Well Owner and retain one for your records.