

WATER WELL RECORD

Form WWC-5

Division of Water Resources App. No. 20110529

1 LOCATION OF WATER WELL: Graham Fraction 1/4 SW 1/4 NW 1/4 NE 1/4 Section Number 13 Township Number T 9 S Range Number R 21 E W Street/Rural Address of Well Location; if unknown, distance & direction from nearest town or intersection: If at owner's address, check here.

2 WATER WELL OWNER The Dane G. Hansen Trust RR#, St. Address, Box # PO Box 187 City, State, ZIP Code Logan, Ks 67646 Don Benoit 209 N Oak St Damaris 67632 Global Positioning System (GPS) information: Latitude: Longitude: Elevation: Datum: WGS 84, NAD 83, NAD 27 Collection Method: GPS unit, Digital Map/Photo, Topographic Map, Land Survey Est. Accuracy: <3 m, 3-5 m, 5-15 m, >15 m

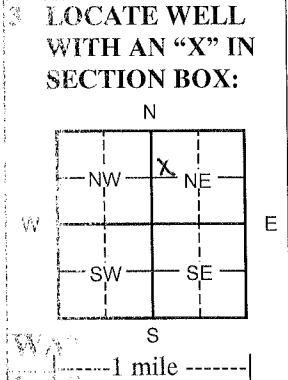

4 DEPTH OF COMPLETED WELL 43 ft. Depth(s) Groundwater Encountered (1) ft. (2) ft. (3) ft. WELL'S STATIC WATER LEVEL ft. below land surface measured on mo/day/yr Pump test data: Well water was ft. after hours pumping gpm EST. YIELD gpm: Well water was ft. after hours pumping gpm WELL WATER TO BE USED AS: Public water supply, Geothermal, Injection well, Domestic, Feedlot, Oil field water supply, Dewatering, Other (Specify below), Irrigation, Industrial, Domestic-lawn & garden, Monitoring well Was a chemical/bacteriological sample submitted to Department? Yes No If yes, mo/day/yr sample was submitted Water Well Disinfected? Yes No

5 TYPE OF CASING USED: Steel, PVC, Other CASING JOINTS: Glued, Clamped, Welded, Threaded Casing diameter 4.5 in. to 23 ft., Diameter in. to ft., Diameter in. to ft. Casing height above land surface 18 in., Weight 2.38 lbs./ft. Wall thickness or gauge No. 248

TYPE OF SCREEN OR PERFORATION MATERIAL: Steel, Stainless Steel, PVC, Other (Specify), Brass, Galvanized Steel, None used (open hole) SCREEN OR PERFORATION OPENINGS ARE: Continuous Slot, Mill slot, Gauze wrapped, Torch cut, Drilled holes, None (open hole), Louvered shutter, Key punched, Wire wrapped, Saw cut, Other (specify) SCREEN-PERFORATED INTERVALS: From 23 ft. to 43 ft., From ft. to ft., From ft. to ft. GRAVEL PACK INTERVALS: From 5 ft. to 43 ft., From ft. to ft., From ft. to ft.

6 GROUT MATERIAL: Neat cement, Cement grout, Bentonite, Other About Intervals From 0 ft. to 5 ft. From ft. to ft. From ft. to ft. What is the nearest source of possible contamination: Septic tank, Lateral lines, Pit privy, Livestock pens, Insecticide storage, Other (specify below), Sewer lines, Cesspool, Sewage lagoon, Fuel storage, Abandoned water well, Watertight sewer lines, Seepage pit, Feedyard, Fertilizer storage, Oil well/gas well, None Direction from well Distance from well

Table with columns: FROM, TO, LITHOLOGIC LOG, FROM, TO, LITHO. LOG (cont.) or PLUGGING INTERVALS. Rows: 0-2 Surface, 2-14 Fine to med sd & gravel, 14-40 Black shale.

7 CONTRACTOR'S OR LANDOWNER'S CERTIFICATION: This water well was constructed, reconstructed, or plugged under my jurisdiction and was completed on (mo/day/year) 11-10-11 and this record is true to the best of my knowledge and belief. Kansas Water Well Contractor's License No. 554 This Water Well Record was completed on (mo/day/year) 11-14-11 under the business name of Woofter Pump & Well Inc. by (signature) Amy Caldwell

INSTRUCTIONS: Please fill in blanks and check the correct answers. Send three copies (white, blue, pink) to Kansas Department of Health and Environment, Bureau of Water, Geology Section, 1000 SW Jackson St., Suite 420, Topeka, Kansas 66612-1367. Telephone 785-296-5522. Send one to WATER WELL OWNER and retain one for your records. Include fee of \$5.00 for each constructed well. Visit us at http://www.kdheks.gov/waterwell/index.html.