

CORRECTION(S) TO WATER WELL RECORD (WWC-5)  
(to rectify lacking or incorrect information)

County: Sheridan

Location listed as:

Section-Township-Range: 20-9-26 W

Fraction ( 1/4 1/4 1/4): NW NW NW

Location changed to:

\_\_\_\_\_

\_\_\_\_\_

Other changes: Initial statements: Contractor completion date listed as 6-01-2010

Changed to: Completion date 6-01-2011

Comments: \_\_\_\_\_

verification method: Changes per phone conversation with woofler on 2-23-2012

initials: SM date: 2-23-2012

submitted by: Kansas Geological Survey, Data Resources Library, 1930 Constant Ave., Lawrence, KS 66047-3726  
to: Kansas Dept of Health & Environment, Bureau of Water, 1000 SW Jackson, Suite 420, Topeka, KS 66612-1367.

**WATER WELL RECORD**

**Form WWC-5**

Division of Water Resources App. No. \_\_\_\_\_

**1 LOCATION OF WATER WELL:** Fraction Sheridan  $\frac{1}{4}$  NW  $\frac{1}{4}$  NW  $\frac{1}{4}$  NW  $\frac{1}{4}$  Section Number 20 Township Number T 9 S Range Number R 26  E  W

Street/Rural Address of Well Location; if unknown, distance & direction from nearest town or intersection: If at owner's address, check here  **7 miles south 7 10 miles east of Hoxie, Ks**

**Global Positioning System (GPS) information:**  
 Latitude: \_\_\_\_\_ (in decimal degrees)  
 Longitude: \_\_\_\_\_ (in decimal degrees)  
 Elevation: \_\_\_\_\_  
 Datum:  WGS 84,  NAD 83,  NAD 27  
 Collection Method:  
 GPS unit (Make/Model: \_\_\_\_\_)  
 Digital Map/Photo,  Topographic Map,  Land Survey  
 Est. Accuracy:  <3 m,  3-5 m,  5-15 m,  >15 m

**2 WATER WELL OWNER** Bradley Simon  
 RR#, St. Address, Box # 7037 S Road 130 E  
 City, State, ZIP Code Hoxie, Ks 67740

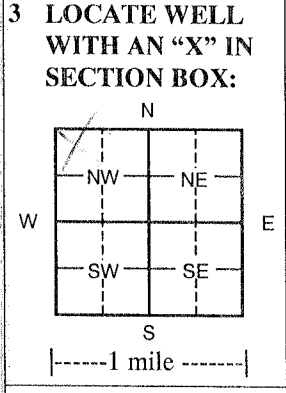

**4 DEPTH OF COMPLETED WELL** 137 ft.

Depth(s) Groundwater Encountered (1) \_\_\_\_\_ ft. (2) \_\_\_\_\_ ft. (3) \_\_\_\_\_ ft.

WELL'S STATIC WATER LEVEL 113.9 ft. below land surface measured on mo/day/yr

Pump test data: Well water was \_\_\_\_\_ ft. after \_\_\_\_\_ hours pumping \_\_\_\_\_ gpm

EST. YIELD \_\_\_\_\_ gpm: Well water was \_\_\_\_\_ ft. after \_\_\_\_\_ hours pumping \_\_\_\_\_ gpm

WELL WATER TO BE USED AS:  Public water supply  Geothermal  Injection well  
 Domestic  Feedlot  Oil field water supply  Dewatering  Other (Specify below) Observation Well  
 Irrigation  Industrial  Domestic-lawn & garden  Monitoring well

Was a chemical/bacteriological sample submitted to Department?  Yes  No  
 If yes, mo/day/yr sample was submitted \_\_\_\_\_

Water Well Disinfected?  Yes  No

**5 TYPE OF CASING USED:**  Steel  PVC  Other

CASING JOINTS:  Glued  Clamped  Welded  Threaded

Casing diameter 4.5 in. to 97 ft., Diameter \_\_\_\_\_ in. to \_\_\_\_\_ ft., Diameter \_\_\_\_\_ in. to \_\_\_\_\_ ft.  
 Casing height above land surface 18 in., Weight 2.38 lbs./ft. Wall thickness or gauge No. .248

TYPE OF SCREEN OR PERFORATION MATERIAL:  
 Steel  Stainless Steel  PVC  Other (Specify) \_\_\_\_\_  
 Brass  Galvanized Steel  None used (open hole)

SCREEN OR PERFORATION OPENINGS ARE:  
 Continuous Slot  Mill slot  Gauze wrapped  Torch cut  Drilled holes  None (open hole)  
 Louvered shutter  Key punched  Wire wrapped  Saw cut  Other (specify) \_\_\_\_\_

SCREEN-PERFORATED INTERVALS: From 97 ft. to 137 ft., From \_\_\_\_\_ ft. to \_\_\_\_\_ ft.  
 From \_\_\_\_\_ ft. to \_\_\_\_\_ ft., From \_\_\_\_\_ ft. to \_\_\_\_\_ ft.

GRAVEL PACK INTERVALS: From 20 ft. to 137 ft., From \_\_\_\_\_ ft. to \_\_\_\_\_ ft.  
 From \_\_\_\_\_ ft. to \_\_\_\_\_ ft., From \_\_\_\_\_ ft. to \_\_\_\_\_ ft.

**6 GROUT MATERIAL:**  Neat cement  Cement grout  Bentonite  Other

Grout Intervals From 0 ft. to 20 ft. From \_\_\_\_\_ ft. to \_\_\_\_\_ ft. From \_\_\_\_\_ ft. to \_\_\_\_\_ ft.

What is the nearest source of possible contamination:  
 Septic tank  Lateral lines  Pit privy  Livestock pens  Insecticide storage  Other (specify below)  
 Sewer lines  Cesspool  Sewage lagoon  Fuel storage  Abandoned water well  
 Watertight sewer lines  Seepage pit  Feedyard  Fertilizer storage  Oil well/gas well None

Direction from well \_\_\_\_\_ Distance from well \_\_\_\_\_

FROM	TO	LITHOLOGIC LOG	FROM	TO	LITHO. LOG (cont.) or PLUGGING INTERVALS
0	2	Surface	101	111	Fine to med sand & small gravel w/clay lens
2	15	Loess	111	115	Fine to some med sand w/clay & caliche strk
15	25	Fine to med sand	115	117	Clay
25	31	Clay	117	125	Fine to med sand
31	50	Sandy clay & caliche strks	125	130	Fine to some med sand w/clay & caliche strk
50	55	Fine to some med sand	130	135	Fine to med sd & small gravel w/caliche
55	66	Fine to some med sd w/clay lens			Lenses
66	92	Clay	135		Flint w/yellow ochre strks
92	95	Clay w/sand strks			
95	101	Fine to some med sand			

**7 CONTRACTOR'S OR LANDOWNER'S CERTIFICATION:** This water well was constructed, reconstructed, or  plugged under my jurisdiction and was completed on (mo/day/year) 06-01-2010 and this record is true to the best of my knowledge and belief. Kansas Water Well Contractor's License No. 554. This Water Well Record was completed on (mo/day/year) 01-16-2012 under the business name of Woofter Pump & Well Inc. by (signature) \_\_\_\_\_

**INSTRUCTIONS:** Please fill in blanks and check the correct answers. Send three copies (white, blue, pink) to Kansas Department of Health and Environment, Bureau of Water, Geology Section, 1000 SW Jackson St., Suite 420, Topeka, Kansas 66612-1367. Telephone 785-296-5522. Send one to WATER WELL OWNER and retain one for your records. Include fee of \$5.00 for each constructed well. Visit us at <http://www.kdheks.gov/waterwell/index.html>.