

USE TYPEWRITER OR BALL POINT PEN-PRESS FIRMLY, PRINT CLEARLY.

WATER WELL RECORD
KSA 82a-1201-1215

Kansas Department of Health and Environment-Division of Environment (Water well Contractors) Topeka, Kansas 66620

DISA

1. Location of well: County Sherman Fraction NE 1/4 SE 1/4 SE 1/4 Section number 27 Township number T 9 S R 41 E Range number 41 E

2. Distance and direction from nearest town or city: RULETON
Street address of well location if in city: 7 1/2 S
3. Owner of well: TAYLOR & OWENS FARM
R.R. or street: R.R. 3 Box 67
City, state, zip code: Goodland Kansas 67235

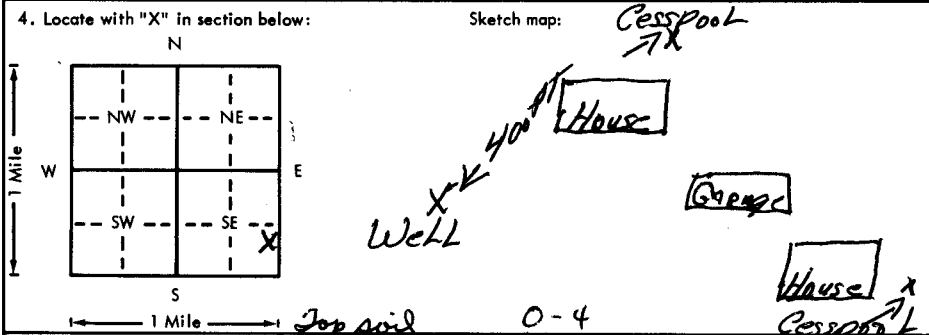

6. Bore hole dia. 8 in. Completion date 7-17-76
Well depth 253 ft.
7. Cable tool Rotary Driven Dug
 Hollow rod Jetted Bored Reverse rotary
8. Use: Domestic Public supply Industry
 Irrigation Air conditioning Stock
 Lawn Oil field water Other
9. Casing: Material Plastic Height: Above or below
Threaded Welded Surface 12 in.
RMP PVC Weight lbs./ft.
Dia. 4 in. to 223 ft. depth Wall Thickness: inches or
Dia. in. to ft. depth gage No. 200 237

5. Type and color of material

Material	From	To
<u>M GRAVEL, SANDY CLAY</u>	<u>130</u>	<u>169</u>
<u>M GRAVEL</u>	<u>169</u>	<u>183</u>
<u>M GRAVEL, SANDY CLAY, SANDSTONE</u>	<u>183</u>	<u>202</u>
<u>SANDY CLAY, SANDSTONE</u>	<u>202</u>	<u>205</u>
<u>M GRAVEL, SANDY CLAY</u>	<u>205</u>	<u>223</u>
<u>HARD SANDSTONE</u>	<u>223</u>	<u>226</u>
<u>M GRAVEL SANDSTONE</u>	<u>226</u>	<u>239</u>
<u>HARD SANDSTONE</u>	<u>239</u>	<u>240</u>
<u>M GRAVEL</u>	<u>240</u>	<u>248</u>
<u>Ochre</u>	<u>248</u>	<u>253</u>
<u>BROCK 248'</u>		

10. Screen: Manufacturer's name Jess + Lowell
Type LOUVER Dia. 5"
Slot/gauze 18 258 Length 20
Set between 223 ft. and 253 ft.
Gravel pack? YES Size range of material 18
11. Static water level: 132 ft. below land surface Date 7-6-76 mo./day/yr.
12. Pumping level below land surfaces:
162 ft. after 2 hrs. pumping 20 g.p.m.
Estimated maximum yield 50 g.p.m.
13. Water sample submitted: mo./day/yr.
 Yes No Date
14. Well head completion:
 Pitless adapter inches above grade
15. Well grouted? YES
With: Neat cement Bentonite Concrete
Depth: From 5 ft. to 15 ft.
16. Nearest source of possible contamination:
ft. 400 Direction NE Type Cesspool
Well disinfected upon completion? Yes No
17. Pump:
Manufacturer's name Red Jacket Not installed
Model number 1580 HP 1 Voltage 220
Length of drop pipe 165 ft. capacity 10 g.p.m.
Type:
 Submersible Turbine
 Jet Reciprocating
 Centrifugal Other

18. Elevation: 3835
19. Remarks:
20. Water well contractor's certification:
This well was drilled under my jurisdiction and this report is true to the best of my knowledge and belief.
L H Drilling Co Inc 166
Business name Goodland Kan License No.
Address
Signed Bill Clifford Date 7-20-76
Authorized representative

- 9 4 L 27 1/4 NE SE SE